

# SPRINT SERIES

## HOT FOIL OVERPRINTERS

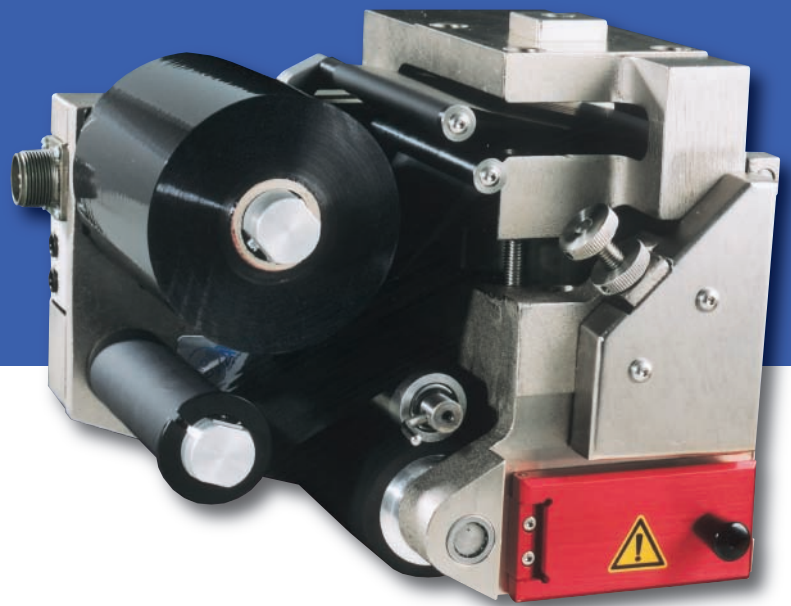

The SPRINT range of Hot Foil overprinters is cost effective, robust and manufactured to very high standards. Three models are available with maximum print areas ranging from 60 x 25mm to 100 x 100mm. The printers are compact for their print capabilities allowing simple installation on to any reel fed packaging or labelling machinery.

### FEATURES

- ▶ Sprint - print area - 60 x 25mm
- ▶ Sprint Major - print area - 100 x 50mm
- ▶ Sprint 100 - print area - 100 x 100mm
- ▶ 305 metre (1,000ft) foil capacity
- ▶ Left and right hand versions available
- ▶ Digital electronic control unit with fault display
- ▶ Fully variable temperature control
- ▶ Interlocked type holder access door
- ▶ Quality engineered product
- ▶ Easy to install on packaging and labelling machines
- ▶ Positive foil drive with infinite adjustment
- ▶ Stainless steel air cylinder
- ▶ Full safety specification



*World Class Coding & Marking Systems*



*getting you  
up to speed*

# SPRINT SERIES



## SPECIFICATIONS

	SPRINT	SPRINT MAJOR	SPRINT 100
Print Area	60 x 25mm	100 x 50mm	100 x 100mm
Operating Speed – Maximum	700 per minute	300 per minute	150 per minute
Foil Width – Maximum	61mm	108mm	110mm
Cycle Time – Minimum	75 milliseconds	175 milliseconds	375 milliseconds
Air Cylinder	40 dia x 13mm	70 dia x 13mm	100 dia x 19mm
Free Air Consumption per Cycle	228cc @ 6.8 bar	718cc @ 6.8 bar	940cc @ 6.8 bar
Print Head Dimensions	195 x 195 x 155mm	250 x 195 x 210mm	277 x 222 x 200mm
Print Head Weight	4.65kg	8.5kg	14kg
Warm-up Time from cold	Typically 5 minutes	Typically 8 minutes	Typically 6 minutes
End of Foil Alarm	Optional		
Foil Capacity	305m (1,000ft)		
Foil Feed Adjustment	Positive, accurate and infinitely adjustable		
Operating Air Pressure	4.0 to 6.8 bar (60 to 100 PSI)		
Dwell Time Range	12 - 650 milliseconds		
Temperature Range	Variable between 70 and 220°C		
Operating Voltage	110/240v AC, 50/60 Hz		
Control Unit Dimensions	240 x 145 x 66mm		

## INSTALLATION DETAILS

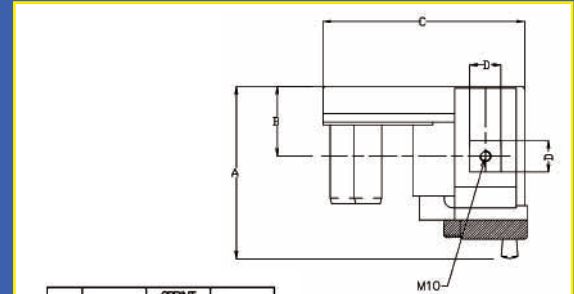

	SPRINT	SPRINT MAJOR	SPRINT 100
A	157	237	210
B	64	102	102.5
C	186	221	277
D	28.5	28.5	50
E	222	258	309
F	40	54	83
G	192.5	192.5	221.5

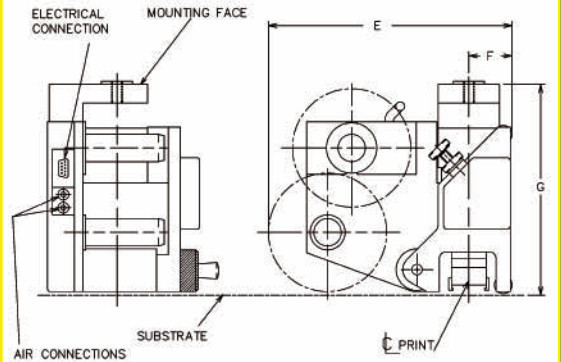

## MOUNTING FRAME

The optional Sprint/Sprint Major mounting frame is the basis for most installations. It can be supplied in a standard form or ready adapted to suit specific parent machinery.

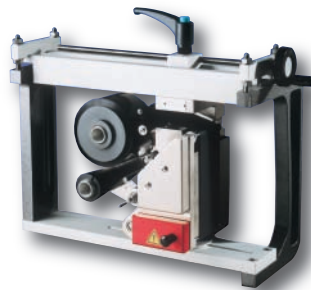

## CONTROL UNIT

The Sprint's digital display controller enables simple yet precise control of print dwell times and operating temperatures to provide the optimum print quality. It features indicators for end of foil, open door, heater failure and temperature sensor failure.



**PPMA**

**OPEN  
DATE**

**Open Date Equipment Ltd**  
Units 8 & 9 Puma Trade Park  
145 Morden Road  
Mitcham, Surrey, CR4 4DG.  
**UNITED KINGDOM**  
Tel: +44 (0)20 8655 4999  
Fax: +44 (0)20 8655 4990  
Email: sales@opendate.co.uk  
Web site: www.opendate.co.uk

**Open Date Systems Inc**  
Springfield Road, PO Box 538  
Georges Mills, NH 03751  
**U.S.A.**  
Tel: +(1) 603 763 3444  
Fax: +(1) 603 763 4222  
Toll free: 877-OPENDATE  
Email: info@opendate.com  
Web site: www.opendate.com

**Open Date France**  
Z.I. D'Attichy  
60350 Attichy  
**France**  
Tel: +33 (0) 344 42 94 43  
Fax: +33 (0) 344 42 17 17  
Email: info@opendatefrance.com  
Web site: www.opendatefrance.com

**Open Date GmbH**  
Mittlere Stämmig 4  
97297 Üttingen  
**Germany**  
Tel: +49 (0) 9369 98 24 0  
Fax: +49 (0) 9369 98 24 24  
Email: sales@opendate.de  
Web Site: www.opendate.de