

5000 SERIES



LARGE AREA, HOT FOIL PRINTERS

The Open Date 5000 Series automatic hot foil overprinters are high quality heavy duty machines. They are designed to be attached to reel fed packaging machines providing a large area on-line printing facility for logos, graphics, dates, prices, batch codes, ingredients lists, bar codes etc.

Given their large print areas, 5000 series printers can also span multiple lanes on sachet and labelling machines enabling a single printer to be used instead of one smaller printer per lane.

Prints are clear, dry, non-toxic, and are of a quality that is not matched by any other in-line overprinting process.

FEATURES

- Model 5000S – print area 150mm x 50mm
- Model 5000SP – print area 150mm x 100mm
- 305 metre (1000ft) foil capacity
- Simple, reliable electronic controls
- electronic control unit – optional
- Fully variable temperature control
- Integral solenoid valve
- Interlocked type holder access door
- Positive foil drive with infinite adjustment
- Slide-in type holder with magnetic lock
- Full safety specification.



5000 SERIES

SPECIFICATIONS

MODEL 5000S

MODEL 5000SP

Print Area	150 x 50mm (6" x 2")	150 x 100mm (6" x 4")
Operating Speed - Maximum	100 per minute	100 per minute
Main Air Cylinder	75 dia x 13mm	125 dia x 13mm
Print Head Dimensions	396 x 232 x 330mm	435 x 259 x 335mm
Print Head Weight	18kg (39lbs)	23kg (50lbs)
End of Foil Alarm	Optional	
Foil Capacity	305m (1000ft)	
Foil Width - Maximum	165mm (6 1/2")	
Foil Feed Adjustment	Positive, accurate and infinitely adjustable	
Operating Air Pressure	4.0 to 6.8 bar (60 to 100 PSI)	
Dwell Time Range	12 - 650 milliseconds	
Temperature Range	Variable between 70 and 220 degrees C	
Operating Voltage	110/240v AC, 50/60 Hz	
Control Unit Dimensions	240 x 145 x 66mm	

INSTALLATION DIMENSIONS

	5000S	5000SP
A	313	320
B	206	232
C	426	430
D	189	189
E	50	60
F	226	259

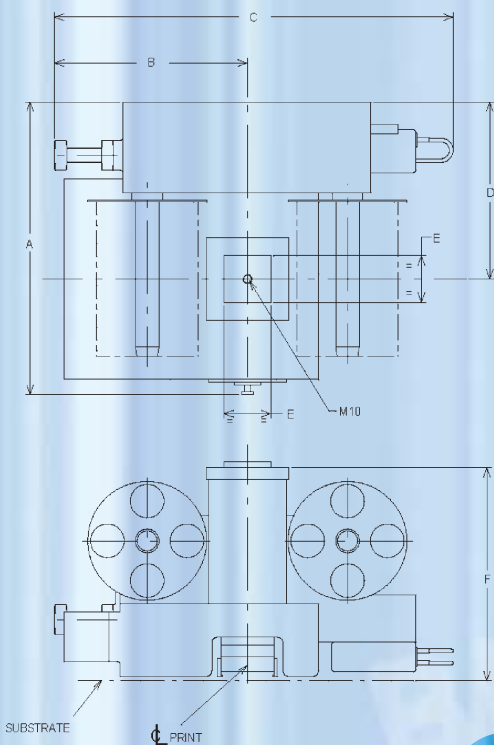

The standard electronic control unit is simple to use and incorporates infinitely variable print dwell and temperature controllers. The optional digital display controller enables the user to enter exact dwell times in milliseconds and temperatures in degrees Centigrade or Fahrenheit. It features indicators for end of foil, open door, heater failure and thermistor failure.



Open Date Equipment Ltd.
Units 8 & 9 Denvale Trade Park
145 Morden Road
Mitcham
Surrey, CR4 4DG. U.K.
Tel: +44 (0)20 8655 4999
Fax: +44 (0)20 8655 4990
Email: sales@opendate.co.uk
Web site: www.opendate.co.uk

Open Date Systems, Inc.
Springfield Road, PO Box 538
Georges Mills, NH 03751
U.S.A.
Tel: + (1) 603 763 3444
Fax: + (1) 603 763 4222
Toll free: 877-OPENDATE
Email: info@opendate.com
Web site: www.OpenDate.com

Open Date France
Z.I. D'Attichy
60350 Attichy
France
Tel: +33 (0) 344 42 94 43
Fax: +33 (0) 344 42 17 17
Email: opendate@wanadoo.fr

Open Date GmbH
Schraggasse 14
97264 Helmstadt
Germany
Tel: +49 (0) 9369 990026
Fax: +49 (0) 9369 990036
Email: sales@opendate.de
Web Site: www.opendate.de